

### Applications:

Provide high quality filtration solutions for water with a high contamination of organic material and algae

### Standard Characteristics:

- **Filter housing material of construction:** Carbon Steel ST37.2
- **Pre-treatment:** sand blasting up to Sa 2.5 grade
- **Exterior & Interior coating:** electrostatic oven baked polyester-epoxy powder coating with a thickness of 150-200 micron
- **Connections:** Victaulic, Threaded socket and Flange
- **Maximum recommended working pressure:** 8 bars (116 psi)
- Equipped with “mushroom” diffusers with vertical openings
- Diffusion protection for screws, nuts & washers



### Type of Media:

- **Volcanic gravel**
- **Quartz Sand**
- **Anthracite:** as a component of dual or multi-media filters for potable water in conjunction with sand (and possibly garnet). The inclusion of a layer of anthracite above the sand ensures longer filter run times. This anthracite layer can produce higher filtration rates than for filters with no anthracite addition thereby reducing the coarse particulate load on the sand.
- **Catalytic media:** manganese dioxide screen washed and dried. Uses; catalytic iron and manganese removal from potable water.
- **Active carbon:** to absorb chlorine and other minerals from water.

Model	ØD		D1		B		L		L1		L2	
	(mm)	(in)	(mm)	(in)	(mm)	(in)	(mm)	(in)	(mm)	(in)	(mm)	(in)
F6016	30	1.5	400	16	500	19.7	180	7.1	1580	62.2	1885	74.2
F6020	50	2	500	20	563	22.2	180	7.1	1675	65.9	2075	81.8
F6024	50	2	600	24	706	27.8	180	7.1	1675	65.9	2075	81.8
F6030	50/75	2/3	750	30	865	34.0	300	11.8	2052	80.8	2185	85.8
F6030P	50/75	2/3	750	30	865	34.0	300	11.8	1650	64.6	2185	85.8
F6036	50/75	2/3	900	36	970	38.19	300	11.8	1990	78.35	2121	83.5
F6036P	50/75	2/3	900	36	970	38.19	300	11.8	1600	62.9	2121	83.5
F6048	50/75	2/3	1220	48	1343	52.9	420	16.5	2160	85.0	2246	88.4
F6048P	50/75/100	2/3/4	1220	48	1343	52.9	420	16.5	1670	65.8	2246	88.4

P = parallel inlet  
Cylinder height – 1500 mm (59.05 in)

**Table 1**

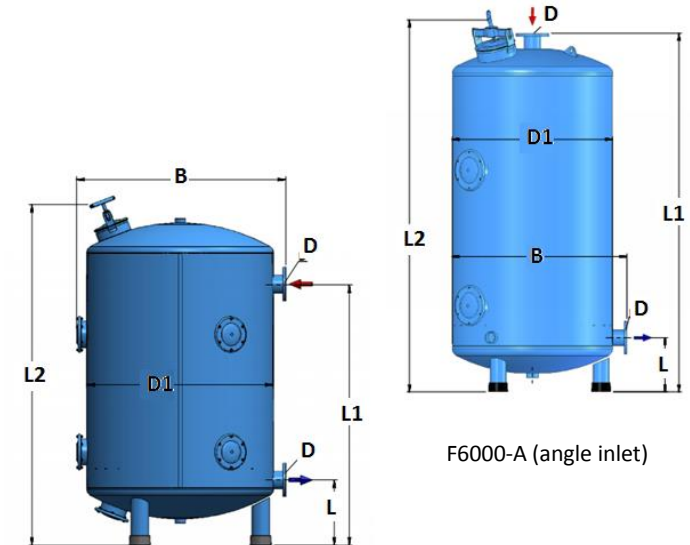

F6000-P (parallel inlet)

F6000-A (angle inlet)

Description	
1	Filter body
2	Handle
3	Tightening bracket
4	Cover
5	Cover gasket
6	“Mushroom” diffuser
7	Rubber bushing
8	Male plug
9	Rubber leg
10	PVC nipple
11	Elbow
12	Service cover 6”
13	Service cover 6” gasket
14	Bolt
15	Washer
16	Nut
17	Male plug

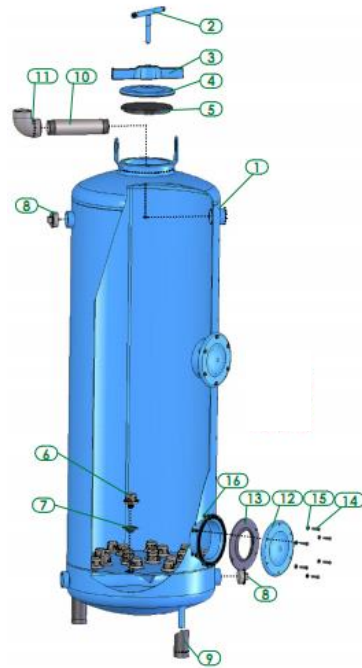

Model F6016 – F6024

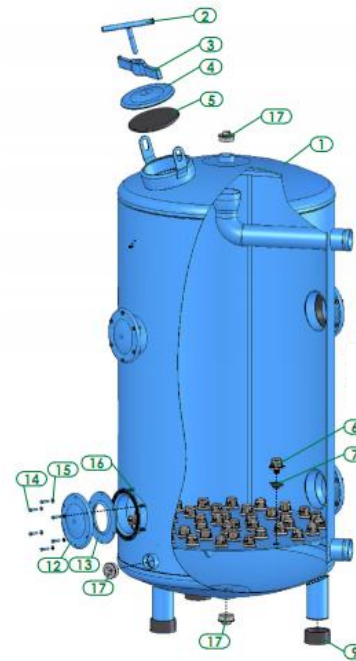

Model F6030 – F6048

Model	Connection ØD *		Filtration area		Recommended Flow Rate			
	mm	in			m <sup>3</sup> /h		GPM	
F6016	30	1.5	0.12	1.29	0.6	1.8	2.6	7.9
F6020	50	2	0.20	2.15	1.0	3.0	4.4	13.2
F6024	50	2	0.30	3.23	2.0	4.0	8.8	17.6
F6030	50/75	2/3	0.44	4.73	3.0	6.0	13.2	26.4
F6036	50/75	2/3	0.63	6.78	4.0	9.0	17.6	39.6
F6048	50/75	2/3	1.13	12.16	6.0	17.0	26.4	74.8

\* See Table 1

