

Applications: fertilizer tanks for use in agricultural applications.

Standard Characteristics:

- **Body of strainer and connections:** Carbon Steel ST37.2
- **Pre-treatment:** sand blasting up to Sa 2.5 grade
- **Available filtration:** 50-3000 micron
- **Exterior & Interior coating:** electrostatic oven baked polyester-epoxy powder coating with a thickness of 150-200 micron
- **Connections:** quick connection
- **Available tank volumes:** 20, 30, 60, 90, 120, 220 liters
- **Installation:** horizontal or vertical
- **Maximum operating working pressure :** up to 8 bar (116 psi).
- Fertilizer tanks require no external energy source to function, other than a pressure differential across the inlet and outlet.
- The oversized pouring mouth reduces the chance of wasted fertilizer during tank filling.
- Flexible and durable rubber joint, highly resistant to corrosion from chemicals used in agriculture.



Operation: The fertilizer tanks are simple to use and maintain. A pressure differential between the inlet and outlet connections, creates flow into the tank, displacing chemical from the tank via the outlet and into the mains.

Model	ØD1 (in)	Volume		H		L		Shipping Weight	
		(lt)	(gal)	(mm)	(in)	(mm)	(in)	(kg)	(lb)
F515	16	20	5.28	525	20.67	406	15.98	18	40
F520	16	30	7.93	600	23.62	406	15.98	23	51
F530	20	60	15.85	690	27.17	495	19.49	29	64
F540	20	90	23.78	831	32.72	497	19.57	37	82
F550	20	120	31.70	1010	39.76	495	19.49	41	90
F560	20	120	31.70	740	29.13	743	29.25	42	93
F570	20	220	58.12	735	28.94	1323	52.09	51	112
F570V	25	220	58.12	1013	39.88	610	24.02	60	132
F580	25	300	79.20	970	38.20	1510	59.45	115	254

Approx. Fertilization time (minutes)							
Pressure loss In/Outlet	Tank capacity						
	BAR	20 Liters	30 liters	60 liters	90 liters	120 liters	220 liters
0.05	20-25	30-40	60-75	105-120	120-135	225-270	330-390
0.1	15-20	20-30	45-60	75-90	90-120	150-165	225-255
0.2	10-15	15-20	30-45	45-60	60-90	105-135	165-195
0.4	6-10	10-15	20-30	30-45	45-75	75-90	90-105
PSI	5 gallons	8 gallons	15 gallons	24 gallons	32 gallons	58 gallons	79 gallons
0.7	5-6.6	8-10.5	15-19	28-32	32-36	60-70	87-103
1.5	4-5	5-8	12-15	20-24	24-32	40-44	60-67
3	2.6-4	4-5	8-12	12-16	15-24	28-36	44-52
6	1.5-2.6	2.6-4	5-8	8-12	12-20	20-24	24-28

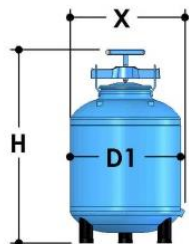

Model F515 – F550, & F570V

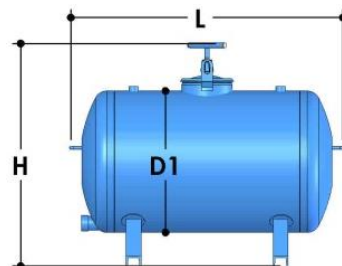

Model F560 - F580

Codes for spare parts

Description		Filter Model									
		F515	F520	F530	F540	F550	F560	F570	F570V	F580	
1	Fertilizer tank body	N/A	N/A	N/A	N/A	N/A	N/A	N/A	N/A	N/A	
2	Handle	E6020106000	E6020106000	E6020106000	E6020106000	E6020106000	E6020106000	E6020106000	E6020106000	E6020106000	
3	Tightening bracket	6012108000-P	6012108000-P	6012108000-P	6012108000-P	6012108000-P	6012108000-P	6012108000-P	6012108000-P	6012108000-P	
4	Cover	5320010800-P	5320010800-P	5320010800-P	5320010800-P	5320010800-P	5320010800-P	5320010800-P	5320010800-P	5320010800-P	
5	Cover gasket	5311200600-120	5311200600-120	5311200600-120	5311200600-120	5311200600-120	5311200600-120	5311200600-120	5311200600-120	5311200600-120	
6	Rubber base leg	5312007600-069	5312007600-069	5312007600-068	5312007600-068	5312007600-068	----	----	----	----	
7	T connector	4190050300	4190050300	4190050300	4190050300	4190050300	4190050300	4190050300	4190100300	4190100300	
8	Nipple	4220050300-030	4220050300-030	4220050300-030	4220050300-030	4220050300-030	4220050300-030	4220050300-030	4220100300-035	4220100300-035	
9	Anti-vacuum valve	E5412013901	E5412013901	E5412013901	E5412013901	E5412013901	E5412013901	E5412013901	E5412013901	E5412013901	
10	Bushing	----	----	----	----	----	----	----	4230100300	4230100300	
11	Elbow	4170050300	4170050300	4170050300	4170050300	4170050300	4170050300	4170050300	4170100300	4170100300	
12	Claw coupling	4252005001	4252005001	4252005001	4252005001	4252005001	4252005001	4252005001	4252010001	4252010001	
13	Claw coupling	4252007001	4252007001	4252007001	4252007001	4252007001	4252007001	4252007001	4252007001	4252007001	
14	Blank plug coupling	4254000001	4254000001	4254000001	4254000001	4254000001	4254000001	4254000001	4254000001	4180206501	
15	Hose	E366660000700-1500-01							E366660000800-2500-01		
16	Inner hose	E366625001600-250	E366625001600-320	E366625001600-450	E366625001600-600	E366625001600-750	E366625001600-600		6106101002	6106101001	

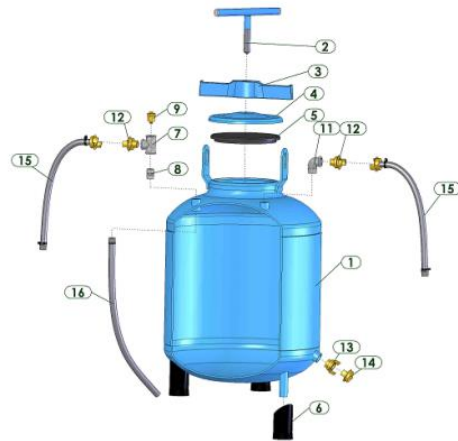

Model F515 – F550,
& F570V

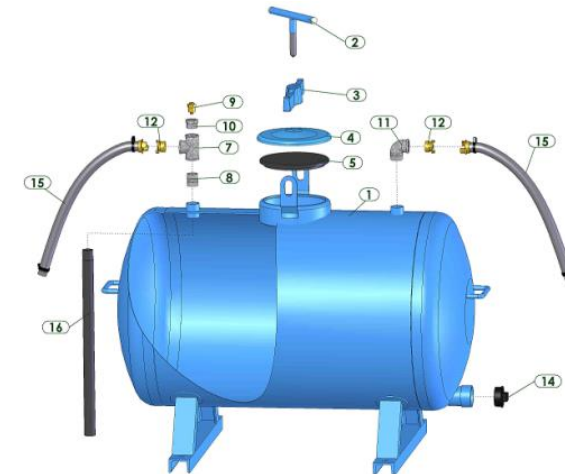

Model F560 - F580