

Applications:

sand separator for well applications

Standard Characteristics:

- **Filter housing material of construction:** Carbon Steel ST37.2
- **Pre-treatment:** sand blasting up to Sa 2.5 grade
- **Exterior & Interior coating:** electrostatic oven baked polyester-epoxy powder coating with a thickness of 150-200 micron
- **Connections:** VIC, Male Threaded and Flange
- **Maximum recommended working pressure:** 10 bars (145 psi).
- Inlet is tangential to the body
- Equipped with anti- vacuum valve
- Conical rubber protection or expendable connection on the joint between hydrocyclone and the sedimentation tank



Operation:

Water enters the hydrocyclone via the tangential inlet which creates a spiral flow along the walls of the filter. The centrifugal force separates the waste and sand particles and pushes them towards the walls of the sand separator. Those particles gravitate downwards and into the sedimentation tank, while clean water moves upwards and exits through the top outlet. For the sand separator to operate correctly, the lead loss must remain between 2-5m. The separation efficiency is not affected by the accumulation of dirt in the sedimentation tank. The sedimentation tank is drained by opening a flush valve for a few seconds manually or automatically by timer.

Model	In/out ØD (in)	Tank (lt)	ØD1 (in)	H		H1		Shipping Weight		Packaging Volume LxWxH		Flow rate		Sediment deposit (liter)
				(mm)	(in)	(mm)	(in)	(kg)	(lb)	(m)	(ft)	(m3/h)	(GPM)	
F710	3/4	1.5	3	475	18.7	380	14.9	8.3	18	0.31x0.31x0.19	1.02x1.02x0.62	2.4 – 4	10.6 – 17.2	1.5
F720	1	1.5	4	600	23.6	460	18.1	10.1	22	0.54x0.28x0.22	1.77x0.92x0.72	3.5 – 6	15.4 – 26.4	2.5
F730	1.5	2.5	6	740	29.1	594	23.4	15.5	34	0.55x0.32x0.28	1.80x1.05x0.92	6.5 – 10	28.6 – 44	5
F740	2	5	8	900	35.4	755	29.7	23.4	52	0.63x0.42x0.30	2.07x1.38x0.94	11 – 19	48.4 – 83.6	5
F750LF	3	5	8	930	36.6	765	30.1	32.5	72	0.67x0.55x0.28	2.20x1.80x0.92	20 – 35	88 – 154	5 (10*)
F750	3	5	8	930	36.6	765	30.1	32.5	72	0.67x0.55x0.28	2.20x1.80x0.92	29 – 45	127.6 – 198	5 (10*)
F755	3*4	60	12	1550	61.0	1285	50.6	75.0	165	1.37x0.77x0.22	4.49x2.53x0.72	45 – 73	198 – 321	30
F760	4	60	16	1765	69.5	1495	58.8	97.5	215	1.26x0.77x0.26	4.13x2.53x0.85	60 – 93	264 – 409	60
F770	6	150	20	1996	78.6	1671	65.8	187.0	412	1.40x1.20x1.00	4.60x3.94x3.28	93 – 155	409 – 682	150
F775	6	150	24	2300	90.5	1940	76.4	230.0	507	1.70x0.90x1.00 Cyclone 1.30x0.77x0.80 Tank	5.6x3.0x3.0 Cyclone 4.3x2.5x2.6 Tank	145 – 225	638 – 990	150(220*)
F780	8	300	30	2897	114.0	2492	98.1	328.0	723	2.10x0.95x1.15 Cyclone 1.40x0.77x1.00 Tank	6.9x3.1x3.8 Cyclone 4.6x2.5x3.3 Tank	200 - 330	880 - 1452	300

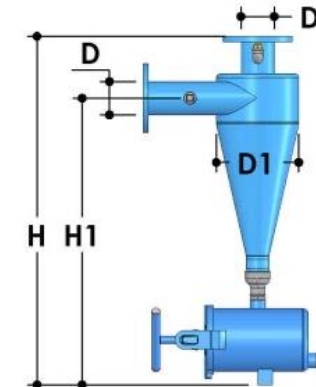

Description of components and information for spare parts

Description		Model									
Filter	F710#001M	F720#001M	F730#002M	F740#005M	F750LF#010V	F750#005M	F755#030M	F760#060F	F770#150F	F775#150F	F780#300F
Filter inlet/outlet	3/4"	1"	1 1/2"	2"	3"	3"	4"x 3"	4"	6"	6"	8"
Chamber capacity Liter	1.5	1.5	2.5	5	10	5	30	60	150	150	300
Chamber	FT001M	FT001M	FT002M	FT005M	FT010V	FT005M	FT030M	FT060F	FT150F	FT150F	FT300F
1 Underflow chamber body	N/A	N/A	N/A	N/A	N/A	N/A	N/A	N/A	N/A	N/A	N/A
2 Handle	E6020104000	E6020104000	E6020104000	E6020106000	E6020106000	E6020106000	E6020106000	----	E6020106000	E6020106000	E6020106000
3 Tightening bracket	6012004000-P	6012004000-P	6012004000-P	6012006000-P	6012006000-P	6012006000-P	6012108000-P	----	6012006000-P	6012006000-P	6012006000-P
4 Cover	5320010400-P	5320010400-P	5320010400-P	5320200601-P	5320200601-P	5320200601-P	5320010801-P	5320010600-P	5320200601-P	5320200601-P	5320200601-P
5 Cover gasket	5312090600-010	5312090600-010	5312090600-010	5311150600-040	5311150600-040	5311150600-040	5312200600-151	5311150600-045	5311150600-040	5311150600-040	5311150600-040
6 Bolt	----	----	----	----	----	----	----	4102110401-030	----	----	----
7 Washer	----	----	----	----	----	----	----	4122110401	----	----	----
8 Nut	----	----	----	----	----	----	----	4112110401	----	----	----
9 Plug	4180056501	4180056501	4180056501	4180076501	4180106501	4180076501	4180156501	4180206501	4180206501	4180206501	----
Separator	----	----	----	----	----	----	----	----	----	----	----
10 Hydrocyclone body	N/A	N/A	N/A	N/A	N/A	N/A	N/A	N/A	N/A	N/A	N/A
11 Plug	----	----	4180056501	4180076501	4180076501	4180076501	4180076501	4180076501	4180076501	4180076501	4180076501
12 Elbow	----	----	4170050300	4170050300	4170050300	4170050300	4170050300	4170050300	4170050300	4170050300	4170050300
13 Anti vacuum valve	----	----	E5412013901	E5412013901	E5412013901	E5412013901	E5412013901	E5412013901	E5412013901	E5412013901	E5412013901
14 Rubber insert	----	----	----	----	5312080600-450	----	----	5312100600	5312150600	5312150600	5312150600
15 Steel insert	E4200100300	E4200100300	E4200150300	E4200200301	----	E4200200301	E4200200300	----	----	----	----
16 Quick coupling	----	----	----	----	4150103000-01P	----	----	----	----	----	----
17 Rubber base for leg	----	----	----	----	----	----	----	5312007600-068	----	----	----
18 Bolt	----	----	----	----	----	----	----	4102160301-070			
19 Nut	----	----	----	----	----	----	----	4112160301			
20 Washer	----	----	----	----	----	----	----	4122160301			

Pressure loss at 130 micron

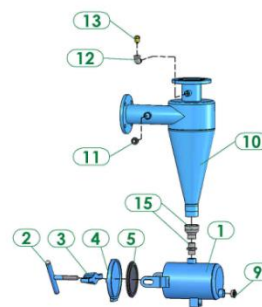
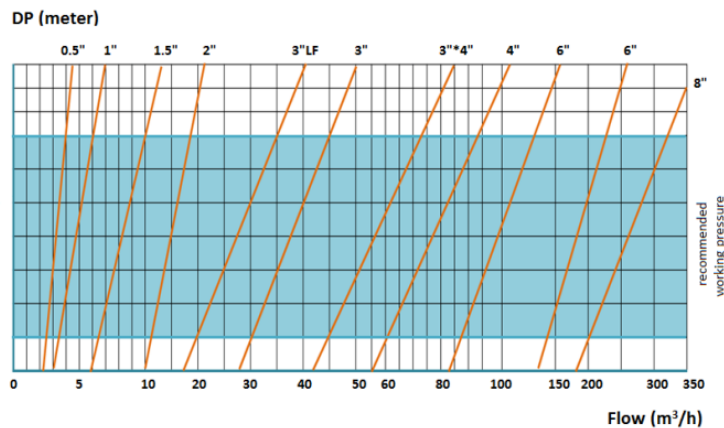

Model F710-F755

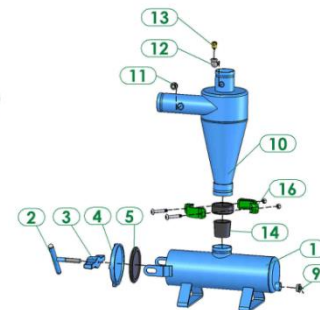

Model F750LF

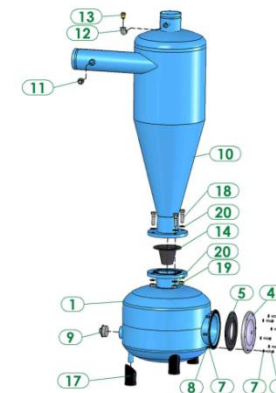

Model F760

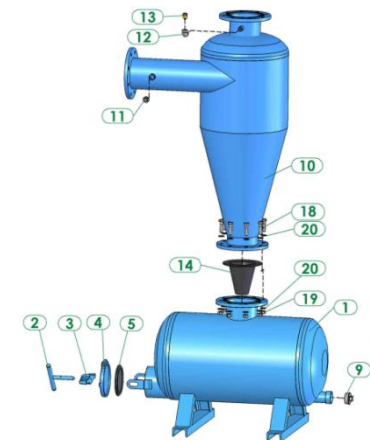

Model F770-F780